

1. Drill holes in wall for mounting and wiring per hole pattern below.
2. Mount Wall Bracket using appropriate screws and anchors (not included).
3. Remove Base Cap and Terminal Block from Base. Punch or Drill out the dimples in bottom of Base.
4. Mount Base to Wall Bracket using Base Gasket and two Screws.
5. Wire Alarm Base per SS-301-R Remote Alarm instructions. Reinstall Terminal Block and Base Cap.
6. Secure Sounder and Light to Base.

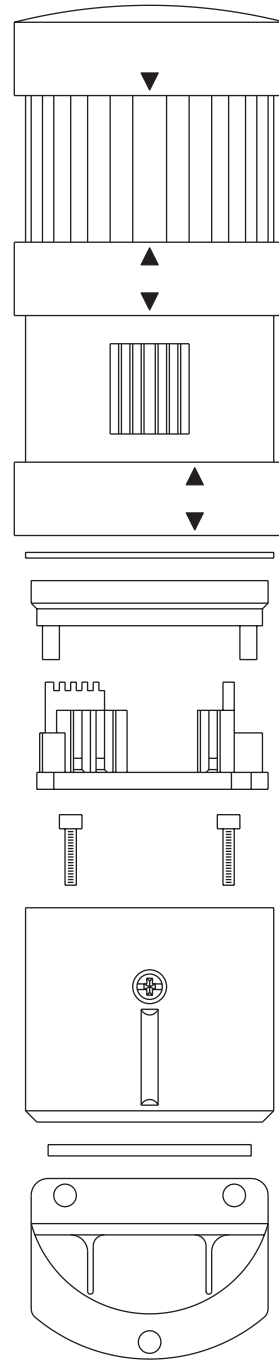

SS-301-R
REMOTE ALARM

O'RING

BASE CAP

TERMINAL BLOCK

SCREW (2 PLCS)

BASE

BASE GASKET

WALL BRACKET

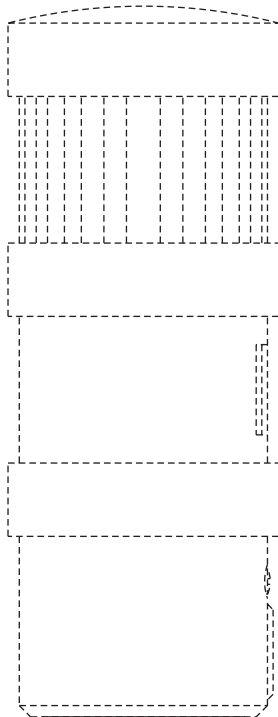

Dimples (2 PLCS)
Punch or Drill

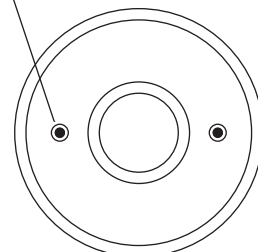

BASE
BOTTOM VIEW

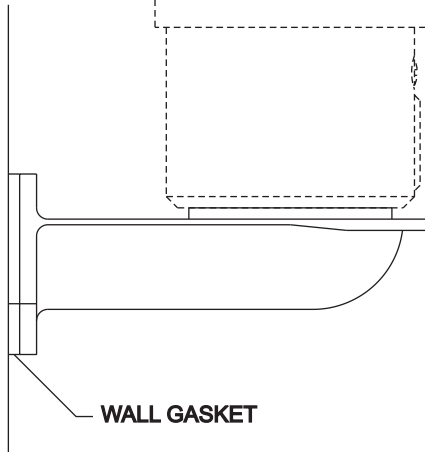

WALL GASKET

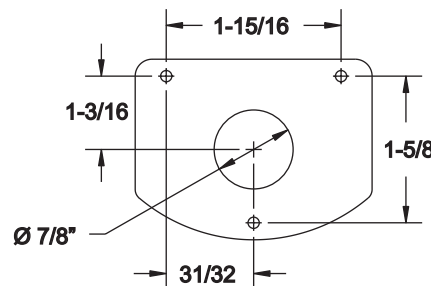

HOLE PATTERN

XVB C12

WALL BRACKET

WALL MOUNTING SS-301-R